

OFFICE SPACE AVAILABLE

555 Taxter Road, Elmsford, New York

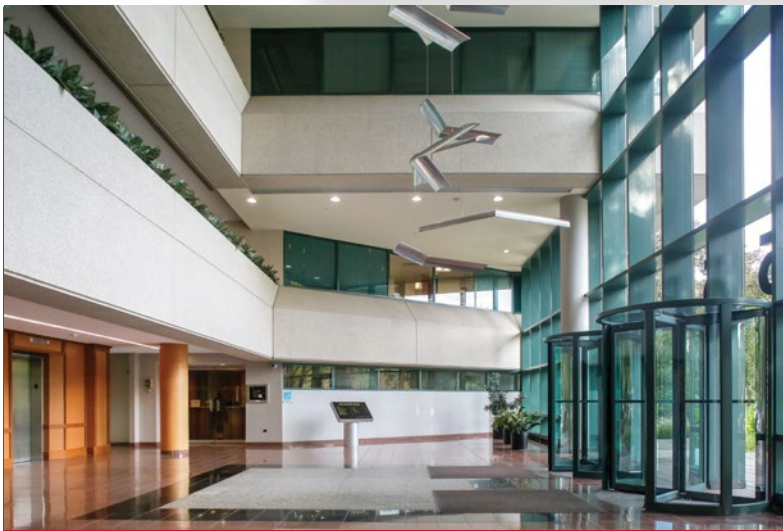

**UNITS FROM 3,500 - 31,000 SQUARE FEET AVAILABLE
REASONABLE SUBDIVISION CONSIDERED**



PROPERTY FEATURES

- Class "A" office building
- 5/1,000 parking ratio, plus additional covered garage parking
- On-site cafe and fitness center
- Outdoor seating/eating areas and walkways on a beautiful 17-acre campus
- Public transportation to Metro-North White Plains and Tarrytown Train Stations
- Immediate access to I-87, I-287, Saw Mill River Parkway and the Mario M. Cuomo Bridge
- Less density than urban office buildings
- Minutes from restaurants, shopping and banking



Brendan Hickey
bhickey@ghpoffice.com

914.642.9300
ghpoffice.com

Rachel Greenspan
rgreenspan@ghpoffice.com

We Own. We Manage. We Lease.